

# Instructions for the collection of a genital swab for the detection of group B streptococcus (GBS)

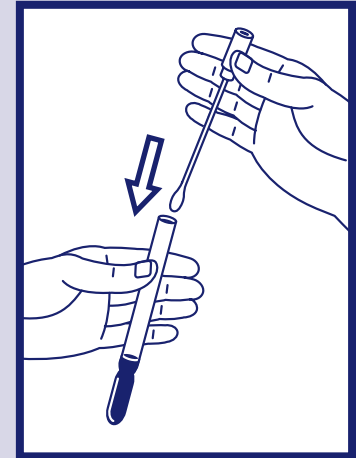
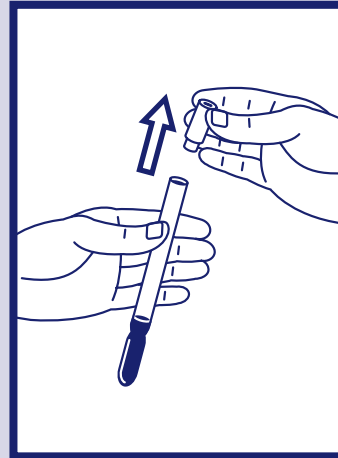
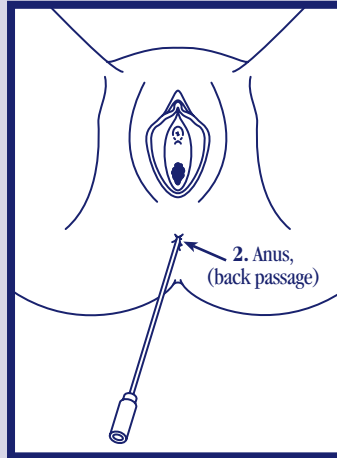
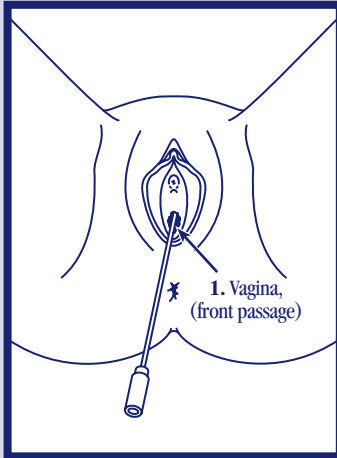

1. Remove swab from packaging. Insert swab 2cm into vagina, (front passage). Do not touch cotton end with fingers.
2. Insert the **same** swab 1cm into anus, (back passage).
3. Remove cap from sterile tube.
4. Place swab into tube. Ensure cap fits firmly.
5. Make sure swab container is fully labelled with name, u.r. number, date and time of collection. Place swab container into transport bag and hand it to a staff member.